

Addendum No. 2
Date: November 8, 2022

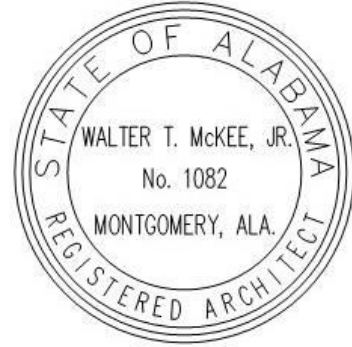

Project:
**Classroom Addition for
Union Hill School for the
Morgan County Schools
Somerville, Alabama**

MCKEE PROJECT NO. 22.134
ALABAMA DIVISION OF CONSTRUCTION MANAGEMENT NO. 2022222

The following changes and/or substitutions to the plans and specifications are hereby made a part of same and are incorporated in full force as part of the contract.

Bidders shall acknowledge receipt of this Addendum in writing on his Proposal Form.

A3.1 GENERAL MODIFICATIONS:

- A. Refer to the **Advertisement for Bids**, **Change** as follows:
1. Sealed proposals will be received only from previously qualified General Contractors by Morgan County Schools located at 235 Highway 67 South, Decatur, Alabama 35603, until **2:00 p.m., Central Time, on Thursday, December 1, 2022**, then opened and read aloud

A3.2 SPECIFICATION MODIFICATIONS:

- A. Refer to attached **Section 13010, Asbestos Removal (Revised 11.8.22) including attached Six Month Surveillance Report (Asbestos Report)**, herein.

A3.3 DRAWING MODIFICATIONS:

- A. See the attached Revised Drawings as follows:
1. Sheet(s) **A0.1 and A0.3 (Revised 11.8.22)**, herein.

END OF ADDENDUM

SECTION 13010 – ASBESTOS REMOVAL

PART 1 – GENERAL

1.1 RELATED DOCUMENTS

- A. Drawings and general provisions of Contract including General and Supplementary Conditions and Division 1 Specification sections apply to work of this section.

1.2 SECTION INCLUDES

- A. Removal of Asbestos Flooring and Ceiling where indicated on drawings.

1.3 DESCRIPTION OF WORK

- A. The Contractor shall remove all asbestos flooring and ceiling as indicated in the drawings. See the attached Asbestos Report.
- B. It shall be the Contractor's responsibility to remove all materials in accordance with all state, federal and local regulations and guidelines. If services of a qualified consultant and qualified asbestos removal Contractor are required, Contractor shall include the cost of these Contractors in his Base Bid. Contractor shall be responsible for proper disposal of material after removal.

PART 2 – PRODUCTS (NOT APPLICABLE)

PART 3 – EXECUTION

3.1 EXECUTION

- A. All work shall be done in compliance with the Guideline of the following agencies and any other having jurisdiction.
 - 1. State of Alabama Asbestos Management Program of Alabama
 - 2. Alabama Department of Environmental Management
 - 3. Environmental Protection Agency
- B. Work includes all of the designated locations of the asbestos material, which includes demolition, removal, and required testing for all clearances, as required, for each identified building being renovated. Verify all pre-renovation testing of units and findings as it relates to the asbestos to be abated.
- C. The name of certified asbestos abatement contractor shall be submitted to the Owner, along with all appropriate registration dates and numbers.
- D. Disposal of these materials shall be in a landfill certified to accept asbestos based materials.
- E. Upon completion of this work, a certificate shall be provided to the Architect, Owner and all required federal and/or state agencies, by the Contractor certifying that all of the asbestos materials and all related items have been properly removed, handled, transported, and disposed of as required by federal and state regulations, including but not limited to: dust, air borne particles, and soil. All certifications shall be received and turned over to the Architect and Owner before anyone begins any work at any building, except for any required work to be accomplished by the General Contractor and/or Subcontractor(s) necessary for Abatement Contractor to begin their work.

3.2 ASBESTOS ABATEMENT PLAN SUBMITTAL

- A. The Abatement Contractor shall furnish and submit to the Architect and Owner:
 - 1. A detailed asbestos PRE-JOB SUBMITTAL PLAN FOR ASBESTOS ABATEMENT and
 - 2. A POSTJOB SUBMITTAL FOR ASBESTOS ABATEMENT.
- B. The Abatement Contractor's plan shall include all procedures required for removal, but not be limited to the following:

1. License/notification, asbestos plan, hazardous communication Plan/MSDS, emergency procedures, product data, insurance, waste shipment record, respiratory protection plan, medical surveillance/safety plan and each employee's certification(s).
- C. The Post-job Submittals shall include, but not be limited to the following: license, insurance, training and worker acknowledgement, daily sign-in sheets, daily logs, disposal manifest, air monitoring and notifications of all removal, testing of units, laboratory approvals indicating that units are clean and free, inside and outside, of all asbestos/lead-based paint materials and all surfaces, air and soil quality is acceptable, and notification that all materials have been removed in an acceptable manner and all wastes disposed of in an approved waste disposal site before any work was allowed to commence on any unit being renovated.
- D. All required forms shall be filed and reports made to all federal and state agencies, including the State of Alabama Department of Public Health, and shall be supplied to the Contractor, the Architect and the Owner.

END OF SECTION

Six Month Surveillance Report

Date Of Inspection: February, 2022

LEA Name : Morgan County Board Of Education

LEA No.: 052

School Name: Union Hill Jr. High School (K-8)

School No.: 017

Building Name: Elem. CR's (4th, 5th, 2nd & 3rd On Lower Level)

Building No.: 003

HA #	Description Of ACBM	Condition Change (Y or N)	Comments
02	12" Light Tan Floor Tile & Mastic Over 9" Floor Tile In Halls	N	
03	9" Tan Floor Tile & Mastic In Classrooms 201, 202, 203 & 204 & In Hall	N	Covered In Some Halls
04	12" Floor Tile Over 9" Floor Tile In Classrooms 205, 206, 207, 208 & 209	N	
05	12" Green Floor Tile In Teacher Workroom, Lower Level	N	

Surveillance Inspector's Name : Lamar Gilliland, ERG Environmental, Inc.

Surveillance Inspector's Alabama Accreditation Number: AIN0222652004

- Z:\2022\22-134 Classroom Addition for Union Hill School\CAD Drawings\Architectural\A0.0 Arch Site Plan.dwg
- Tuesday, November 8, 2022 11:45:35 AM



SITE PLAN PHASE 1 - DEMOLITION AND STAGING
SCALE: 1/16" = 1'-0"

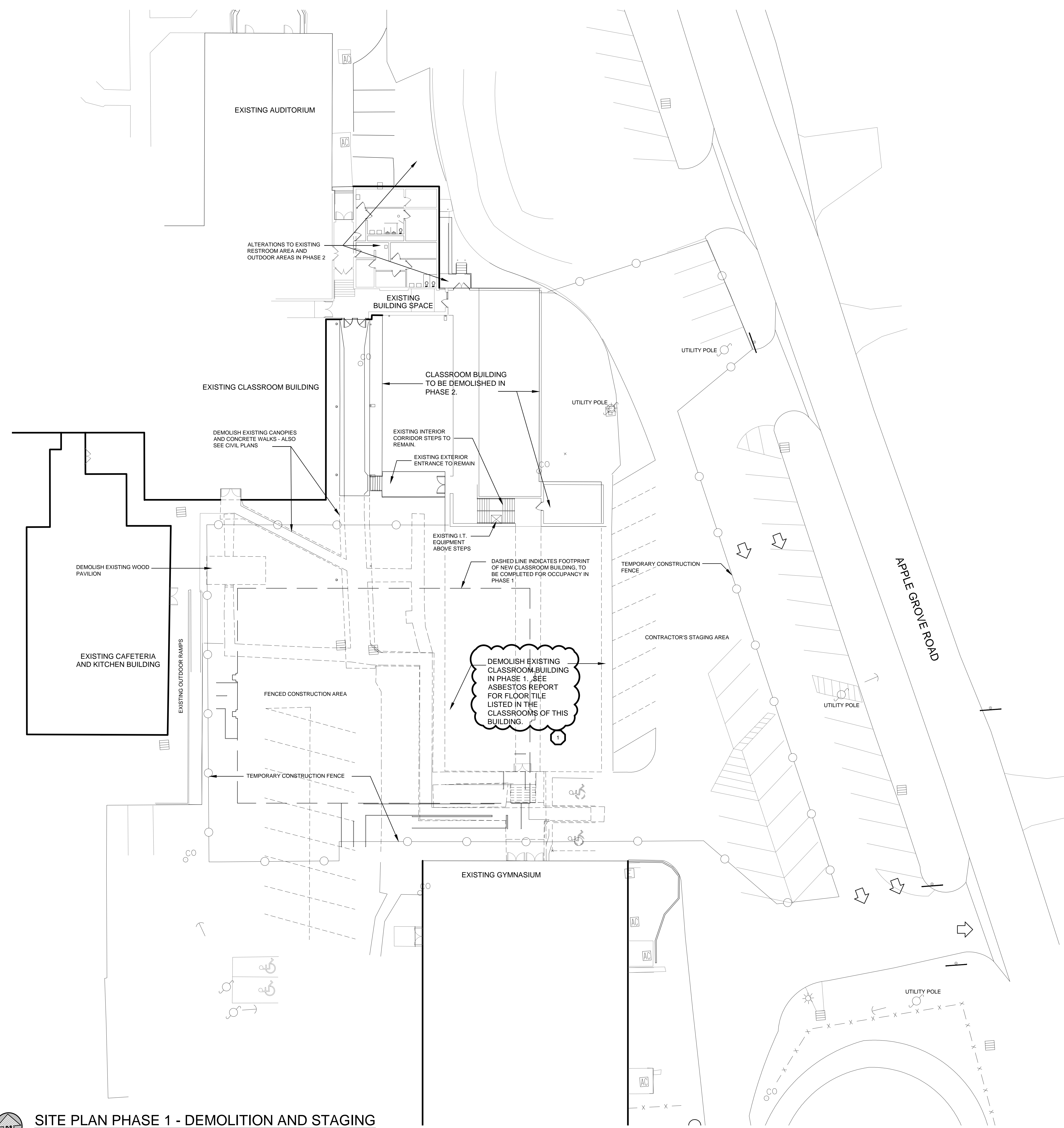

CLASSROOM ADDITION
FOR
UNION HILL SCHOOL
SOMERVILLE, ALABAMA
FOR THE
MORGAN COUNTY BOARD OF EDUCATION

MCKEE and ASSOCIATES
ARCHITECTS, INC.
631 SOUTH HULL STREET, MONTGOMERY, ALABAMA 36104 (334) 834-9933



SHEET TITLE : SITE PLAN PHASE 1 -
DEMOLITION AND
STAGING

MCKEE JOB # : 22-134

DRAWN BY : LB, VH
DATE : 10-13-2022
REVISED DATE : 11-8-2022
REVISED DATE :
REVISED DATE :

SHEET NO. : **A0.1**

- Z:\2022\22-134 Classroom Addition for Union Hill School\CAD Drawings\Architectural\A0.0 Arch Site Plan.dwg
- Tuesday, November 8, 2022 11:42:34 AM

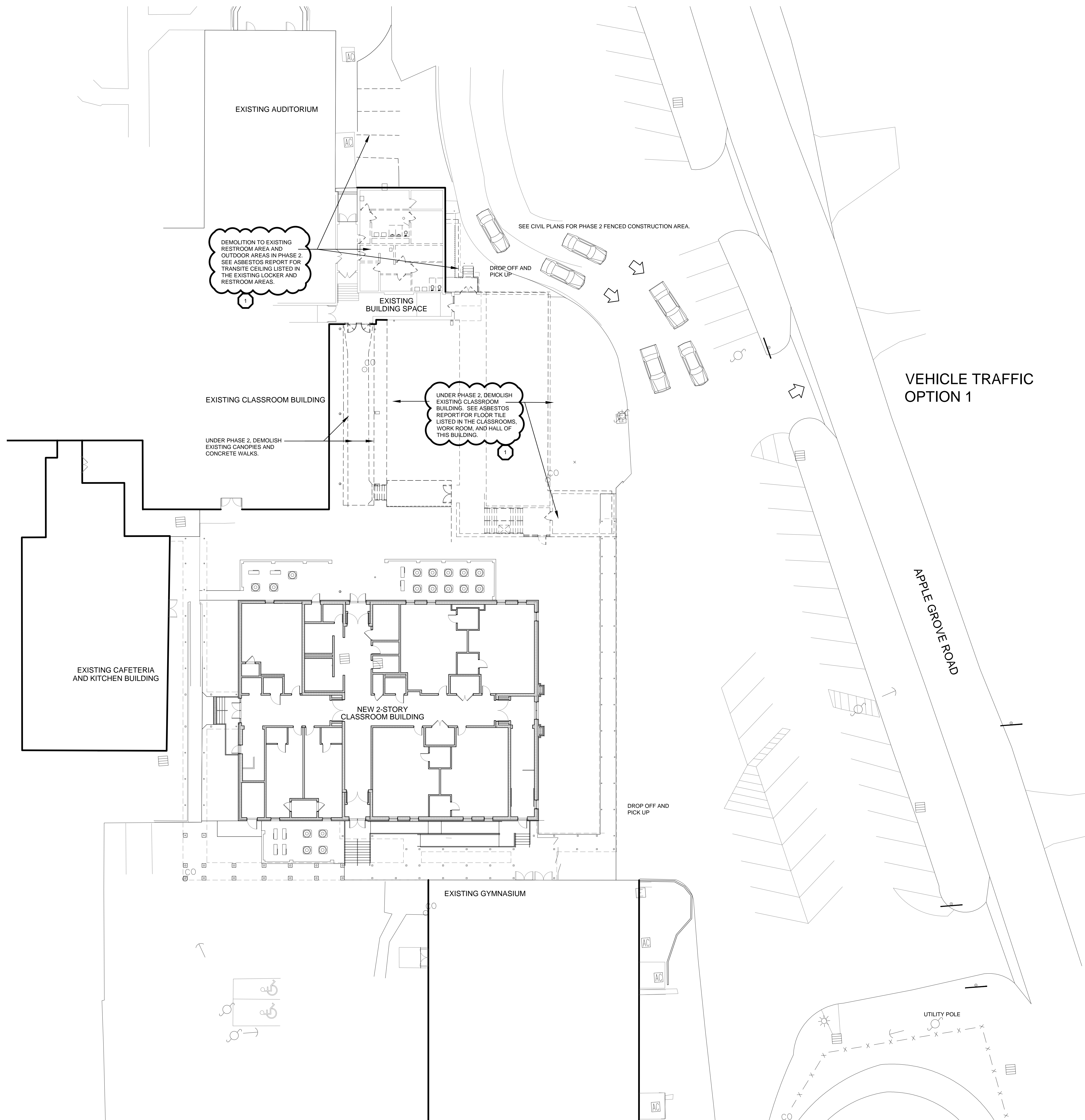

SITE PLAN - PHASE 2 DEMOLITION
SCALE: 1/16" = 1'-0"

CLASSROOM ADDITION
FOR
UNION HILL SCHOOL
SOMERVILLE, ALABAMA
FOR THE
MORGAN COUNTY BOARD OF EDUCATION

MCKEE and ASSOCIATES
ARCHITECTS, INC.

631 SOUTH HILL STREET, MONTGOMERY, ALABAMA 36104 (334) 834-8833

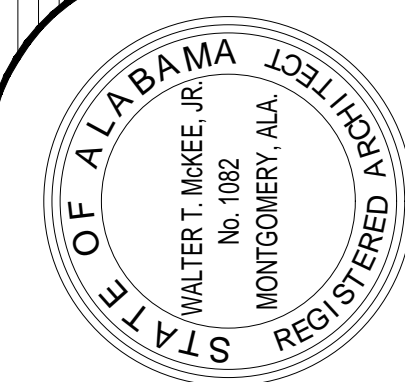

SHEET TITLE : SITE PLAN - PHASE 2 DEMOLITION

MCKEE JOB # : 22-134

DRAWN BY : VH

DATE : 10-13-2022

REVISED DATE : 11-8-2022

REVISED DATE :

REVISED DATE :

SHEET NO. : **A0.3**