

ADDENDUM #1

CLARKE RANGE COMPLEX LIGHTNING PROTECTION SHELTER BUILDINGS CONSTRUCTION

Alexandria, Alabama

Bid Opening Date: April 18, 2024

Bid Documents, plans and specifications, issued date: October 5, 2023

Contract Duration: Three hundred thirty-four (225) calendar days.

OWNER:

The Armory Commission of Alabama
1720 Cong. W.L. Dickinson Dr.
Montgomery, AL

ARCHITECT:

Williams Blackstock Architects
2204 1st Avenue South, Suite 200
Birmingham, AL 35233
ph. 205-252-9811 f. 205-252-9812

PROJECT NUMBERS:

IFB: AC-24-B-0002-S

WBA: 19-054.07

DATE: April 9, 2024

TO: ALL BIDDERS

This addendum forms a part of the Contract Documents and modifies and/or supplements the original Contract Documents dated October 5, 2023.

GENERAL:

1. Attached are the meeting minutes from the Pre-Bid Meeting, Sign-In-Sheet, and Questions with Answers asked during the pre-bid meeting and walk-through.
2. See attached RFI Log with questions and responses.

Architectural:

Sheet A1.1 Site Plan – R1

1. Added plan showing approximate existing elevation change across the site.

Specifications:

1. Updated 00 41 00 Proposal Form to correct the IFB#.
2. Added Section 12 6100 – Fixed Seating - Bleachers

END OF ADDENDUM #1

Attachments:

Pre-Bid Meeting Minutes and Sign-In Sheet

RFI Log

A1.01-R1

00 4100 - Proposal Form

12 6100 – Fixed Seating - Bleachers

**Clarke Range Complex Lightning Protection Shelter Building Construction
Alexandria, AL**

IFB#: AC-24-B-0002-S

PRE-BID CONFERENCE
1:30PM CT, April 4, 2024

- **Sign Attendance Roster/ Introductions**

Receipt of Proposals -All Bidders are to ensure that all required documents are included in the submitted bid proposal. Sealed bids will be received by the Armory Commission of Alabama, at the State Military Department Building, 1720 Cong. W.L. Dickinson Drive, (P.O. Box 3711), Montgomery, Alabama until **2:00 p.m. CDT, Thursday April 18, 2024 for Clarke Range Complex Lightning Protection Shelter Building Construction Alexandria, AL** at which time they will be publicly opened and read in the Second Floor Classroom (Room 201), of the State Military Department, 1720 Cong. W.L. Dickinson Drive, Montgomery, Alabama. If you are attending the bid opening, please arrive at least one hour prior to bid opening time due to possible security screening or other potential delays in entering the base. Bid adjustments are no longer allowed via facsimile. It is the responsibility of the Bidder to ensure that the Bids are in the hands of the Contracting Officer by the appointed time. Any bids that are not in the hands of the Contracting Officer by appointed time may not be accepted.

Arrive 1 hour early to make sure you have sufficient time to get the clearance required to enter the main gate and to sign in at the security desk in the State Military Department Building. Room 201 is above the security desk in the State Military Department Building. If your bid is over \$50,000.00 the bidder must have a General Contractors License number on the outside of the envelope.

Any bid being sent via FedEx, USPS, UPS, etc. should be scheduled to arrive the day before the bid opening to allow the bid package to circulate through the mail system and arrive to the Contracting Officer prior to bid time.

To enter the base you will need a current drivers license, vehicle registration, and insurance card.

- **Construction time** – 225 calendar days from notice to proceed to receipt of project closeout documents. Refer to Section 01 1000, Paragraph 1.5 in the specification manual for exact work and deliverable milestone times. Liquidated Damages will be incurred if all deliverables are not received by the contract end date.
 - A Notice To Proceed will be issued via email with the executed contract to the successful bidder. The NTP will be dated 2 weeks out from the date of the email.
 - The General Contractor has 10 days from the date on the NTP to begin work.
 - Including the time allotted for submittals the G.C. will have 165 days to complete the on site work.
 - The G.C. will have 15 days to complete the punch list.
 - 45 day for closeout document preparation and submittal is included in the 225 calendar days specified in the contract documents.
- **Project Site Access / Security Issues / (Phasing if necessary)**
 - Normal work hours for Clarke Range Complex are Monday - Friday 7:00am to 5:00pm
 - Weekend access requires written request to the architect one week minimum in advance.
- **Bid Items / Alternates** –
 - 1 Bid Item.
 - No Alternates

- **Prior Approval** –No product submittals required.
 - See paragraph 3 & 4 of the Instructions to Bidders and paragraph 2-C-5 of the General Conditions of the Contract.
- **Allowances** – There are no allowances..
- **Bid Document Questions / Clarifications** – RFIs must be received in writing by Kyle Franklin at Williams Blackstock Architects, PC via email at kyle@wba-architects.com no later than 1:00 PM CT on Wednesday April 10, 2024.
- **Payment Information:** The construction contract is a State of Alabama contract and funds will be issued via a State of Alabama check. Beginning with the 3rd payment application, JOBS reports are required and must be submitted once per quarter on the supplied EXCEL spreadsheet.
 - Submit a Pay Application each month.
 - Jobs Reports are required. Breakdown of individual employee & hours they worked at their job. Jobs Reports from prior month must be submitted with pay application.
- **Alabama State Tax Abatement:** Alabama State Sales Taxes DO NOT APPLY. Contractor must review the Bid Form for documentation of estimated State Sales Tax. Any additional questions are to be addressed to Mr Thomas Sims at the Alabama Department of Revenue; his contact number is (334) 242-1574. The Armory Commission of Alabama is NOT responsible for the reimbursement of sales taxes.
 - Fill out all lines on the Bid Form including the lines for accounting of sales tax.
 - Do not add anything to the Bid Form.
- **Utilities:** Contractor is responsible for all needed utilities and restroom facilities during construction.
 - G. C. responsible for own utilities, i.e. water, power, port-a-let, etc.
- **Contractor will be required to provide the following prior to start of work:**
 - Construction Schedule
 - List of all subcontractors
 - Proof of Insurance
 - Schedule of Values and Draw Schedule
 - The winning bidder will need to come to the Pre-Construction meeting with proposed schedule of work for coordination.
 - Subcontractor list is due at the time the signed contract is returned by the G.C.
 - There will be a Pre-Con meeting that the G.C. will be required to attend.
 - If schedule conflicts occur at Pelham Range due to changes in range availability the G.C. is to document the fact that access was denied and include the date of occurrence, personnel who denied access, and send to the architect immediately. Adjustments to the contract duration will be made based on the verification of this documentation.
- **Pay Applications:**
 - Pay applications will be submitted monthly.
 - The pay application will be broken down to cover each individual bid items for the bid items awarded.
- **Closeouts:** 2.5% of the total contract value will be set aside for closeout documents in the schedule of values. Closeout procedures and a closeout checklist are detailed in the specifications.
 - The 2.5% will be retained until all closeout documents have been received and approved. The 2.5% may be submitted on the final pay application that accompany the closeout documents.
 - Closeout Documents Checklist revisions. Revisited section will be issued in addendum.
 - There are new closeout procedures, see attached, that require As-Builts, O&M Manuals, Training documentation, etc. to be brought to the Punch List walk for review. Closeout items must be completed and brought to the Final walk through. Review the attached specification section for more details.

- **Retainage:** Retainage will be 5% of first 50% of the total contract value.
- **Protection of Existing Items:** The contractor must insure that he protects all surrounding work.
 - The General Contractor is responsible for protecting adjacent structures, utilities, asphalt, concrete sidewalks, sod, trees, etc. from damage during demolition and site restoration work. Any damage that occurs shall be the responsibility of the General Contractor to correct back to the pre damaged state.
- **OAC Meetings:** The contractor will conduct monthly OAC meetings at the site as required. The contractor is expected to produce an updated RFI log, Change Order log, and Submittal log at every OAC meeting.
 - OAC meetings will be on site.
 - The G.C. must provide the items listed above at each OAC meeting.
 - Provide, 10 days prior to the meeting, a pay application and change orders to the Architect for review.
- **Rain days:** Rain Days will be given if over and above normal rainfall amounts and all requested rain days must be submitted on a monthly basis.
 - Submittal for rain days at the end of the project for occurrence during the earlier stages of the project will not be considered.
 - See general conditions for criteria to submit. Make sure documentation is correct.
- **Testing Requirements:** All testing is the responsibility of the General Contractor.
- **General Contractors Supervision:** A FULL time employee of the General Contractor MUST be on-site anytime work is being performed.
 - The superintendent will be allowed to look after more than one site at a time on the same base, but the workers at each site must know where the superintendent is at all times.
 - The G.C. may want to designate more than one superintendent.
- **Licensure:** If the total bid is over \$50,000.00 the bidder must have a current Alabama General Contractors License that allows them to do the type of work required for this project. The Owner will verify that the winning bidder has the proper license.
 - If there is any question if you have the proper license ask, in writing, the architect if your license is appropriate for the work prior to the RFI deadline.
- **Bid Bonds:** A Bid Bond of 5% not to exceed \$50,000.00 of the bid amount is required as of May 2016.
- **Ambiguities, Questions, etc.:** See paragraph 3 & 4 of the Instruction to Bidders and paragraph 2-C-5 of the General Conditions of the Contract.
 - If there are any ambiguities in the bid documents that are not answered by RFI per the general conditions the G.C. is to bid the greater quantity and more expensive option.
- **Project Overview**

The project consist of a 50' x 40' pole barn type structure with standing seam metal roof, metal wall panels, interior plywood to 8' A.F.F., reinforced concrete floor slab that is grounded, exterior hollow metal doors and frames, gravel pathway to road, and a lightning protection system in accordance with the specifications and drawings.
- **Questions?**

See RFI Log.

PRE-BID MEETING SIGN-IN SHEET

Project Name: Clarke Range Complex Lightning Protection Shelters

WBA Project Job # 19-054.07

IBF# AC-24-B-0002-S

Date: April 4, 2024

NAME

ORGANIZATION

EMAIL

Ash Mickler

BCS LLC

Teamnicklem@gmail.com

Brad Johnson

CEMO

bradson.h.johnson.nfy@gmail.com

Kyle Franklin

WBA

kyle@wba-architects.com

Michelle Wells

CEMO - D+RM

pamela.m.wells@cmo.com

Lozer Clawver

ALBBA CEMO OPH

Lozer.Clawver@albba.com

Steve Shotts

FMTC - DPW

stevenshotts@fmty.com

Kanda Floyd

Hale Bldg Co.

kanda@halebldg.com

SECTION 00 41 00 – PROPOSAL FORM

(Revision Date: 23 June 2021)

IFB# AC-24-B-0002-S

BID OPENING DATE: April 18, 2024

BIDDER _____

CONTRACTOR'S LICENSE NO. _____

TO: The Armory Commission of Alabama
State Military Property and Disbursing Officer
Headquarters, Alabama National Guard
1720 Cong. W.L. Dickinson Drive
Montgomery, Alabama 36109-0711

PROJECT: Clarke Range Complex Lightning Protection Shelter
Alexandera, Alabama

In compliance with your Invitation for Bid, the undersigned hereby proposes to furnish the plant, labor, materials, and equipment and perform all work for the above described project in strict accordance with the specifications, drawings, and addenda number _____ for consideration of the following prices (bid prices do NOT include Sales or Use Taxes in accordance with Act 2013-205):

BID

PERFORM ALL WORK IN ACCORDANCE WITH THE DRAWINGS & SPECIFICATIONS FOR:
Clarke Range Complex Lightning Protection Shelter Alexandera, Alabama

BASE BID as shown in the bid documents \$ _____

ACCOUNTING OF SALES TAX

Pursuant to Act 2013-205, section 1(g) the Contractor accounts for sales tax NOT in the bid form as follows:

ESTIMATED SALES TAX AMOUNT

BASE BID as shown in the bid documents \$ _____

Failure to provide an accounting of sales tax shall render the bid non-responsive. Other than determining responsiveness, sales tax accounting shall not affect the bid pricing nor be considered in the determination of the lowest responsible and responsive bidder.

TIME LIMIT: These bids are subject to an acceptance period of thirty (30) days.

A. All amounts and totals given will be subject to verification by the State. In case of variation between unit bid price and total shown by bidder, the unit price will be considered to be his bid. The State reserves the right to award the work on the basis of any bid or any combination of bids and to increase or decrease the quantities of any item listed in this bid at the price quoted for that particular item.

B. Bids shall be for the entire work and shall have each blank space filled in to include the "Estimated Sales Tax Accounting".

C. The quantities of each item of the bid as finally ascertained at the close of the contract will determine the total payment to accrue under the contract.

BIDDER _____

D. The bidder, upon request of written notice of award of the contract within thirty (30) days after the date of opening of bids, agrees that he will execute the construction contract in accordance with this bid as accepted, and if the consideration of the contract will exceed \$50,000.00 in amount, will furnish to the State a Performance Bond and a Payment Bond on AGO Forms, with good and sufficient surety or sureties as required by the specifications, at the time the contract is executed.

E. It is hereby warranted that in the event award is made to the undersigned, there will be furnished under this contract or used in the performance of the work covered by this contract, only such unmanufactured articles, materials, and supplies as have been mined or produced in the United States, and only such manufactured articles, materials, or supplies mined, produced or manufactured, as the case may be, in the United States, except as indicated in the bid documents..

F. The bidder further agrees that if awarded the contract, he will commence work within ten (10) calendar days after notice to proceed date and that he will fully complete the work ready for use not later than **180 calendar days** after notice to proceed date.

FIRM NAME _____

ADDRESS _____

PHONE _____

FAX _____

EMAIL _____

BY _____

SIGNATURE

PRINTED NAME _____

TITLE _____

STATE OF ALABAMA
CONTRACTOR'S LICENSE NO. _____

NOTES:

All bidders must be licensed under the provisions of Title 34, Chapter 8, Code of Alabama, 1975, as amended.

On projects bid at \$50,000.00 or more, the bidder must include his license number on the bid form in the prescribed place and on the outside of the envelope containing the bid, or otherwise the bid will not be considered.

Bid Prices do not include Sales or Use Taxes but these taxes are identified in the Estimated Sales Tax Amount section of this bid form.

SECTION 12 6100**FIXED SEATING - BLEACHERS****PART 1 GENERAL****Quality Assurance:**

1. Manufacturer Qualifications:
Manufacturer has a minimum of ten years experience in the design and manufacture of bleachers. Welders must conform to AWS standards.
2. Source Quality Control:
Mill Test Certification.
3. Codes and Standards:
2012/2015 International Building Code / ICC 300 2012.

Engineering:

Engineering certifications and calculations by a Registered Professional Engineer will be provided upon request at an additional fee.

Design:

1. Applicable Codes:
INTERNATIONAL BUILDING CODE (IBC), 2021 EDITION / ICC 300 2012
2. Design Loads:
Live Loads:
Uniform loading - Structure = 100 psf
Uniform loading - Seat and Foot plank = 120 plf
Sway Loads:
Perpendicular to seats = 10 plf
Parallel to seats = 24 plf
Guardrail Loads:
Uniform vertical load = 100 plf
Uniform horizontal load = 50 plf
Concentrated horizontal load = 200 pounds
*Wind Loads:
Basic design wind speed = 150 mph (exposure "B")
3. Bleachers are to be 5 tiers high and 21' in length (seating capacity of 70).

Angle Frame Bleachers:

1. Framework:
Prefabricated aluminum angle spaced at 6' - 0" intervals joined by means of aluminum angle cross bracing.
2. Shop Connections:
Welded to meet AWS standards and local code requirements.
3. Joint Sleeve Assembly:
Internal splices, where required shall be two per joint, and shall penetrate the joint a minimum of 8" in each direction and be riveted at one end only to allow for contraction and expansion.
4. Rise and Depth Dimensions:
6" vertical rise and 24" tread depth, Seat height is 17" above its respective tread.
5. Seats:
Nominal 2" x 10" anodized aluminum with anodized end caps.
6. Treads:
Nominal two (2) 2" x 10" mill finish aluminum with anodized end caps on rows 2 & Up.

7. Risers:

Nominal two (2) 1" x 6" mill finish aluminum with mill finish end caps on top row.

Nominal 1" x 6" mill finish aluminum with mill finish end caps on rows 4 & up.

8. Guardrail:

Rails shall be anodized aluminum tube with end plugs and elbows where required. All Rails shall be secured to angle supports with galvanized fasteners. Top rails at sides, near and front shall be 42" above the leading edge of seat or walking surfaces. Rear rail support members shall be aluminum channel, side and front rail supports shall be aluminum angle.

(A) Chainlink System:

Fencing shall consist of 9 gauge, 2" mesh galvanized chainlink fabric, heavy duty tension bands, tension bars, brace bands, combo rail endcaps, and wire ties.

Materials/Finishes:

1. Framework:

Aluminum:

Structural fabrication with aluminum alloy 6061-T6 mill finish. Each frame shall be unit-welded, using metal inert gas method, under guidelines by the American Welding Society. After fabrication all steel is hot dipped galvanized to ASTM A-123 specifications. All cross bracing and horizontal bracing shall be aluminum alloy 6061-T6 mill finish.

2. Extruded Aluminum:

Seat Planks:

Aluminum alloy 6063-T6, clear anodized 204R1, AA-M10C22A31, Class II with a wall thickness nominally .078" for impact and deformation resistance.

Tread and Riser Planks:

Aluminum alloy 6063-T6, mill finish. With a wall thickness nominally .078" for impact and deformation resistance.

3. Accessories:

Channel End Caps:

Aluminum alloy 6063-T6, clear anodized 204R1, AA-M10C22A31, Class II.

Hardware:

Bolts and Nuts shall be hot dipped galvanized.

Hold Down Clip Assembly:

Aluminum alloy 6063-T6 mill finish.

Joint Sleeve Assembly:

Aluminum alloy 6061-T6, mill finish.

Installation:

Install bleacher unit in accordance with manufacturer written instructions and shop drawings. Bleachers are to be anchored to the concrete slab per manufacturer's recommendations.

CLARKE RANGE COMPLEX
 LIGHTNING PROTECTION SHELTER
 Alexandria, Alabama

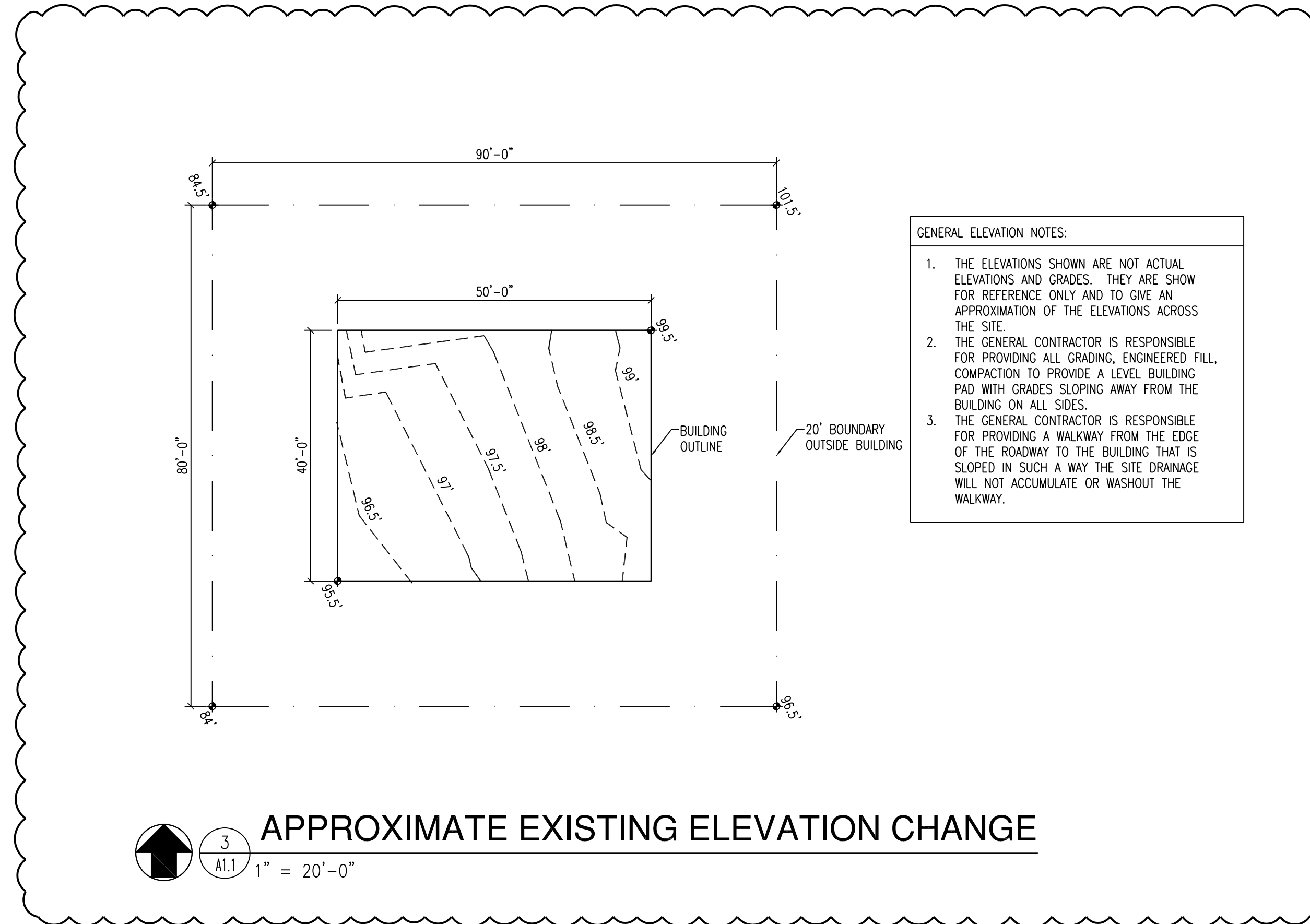

- GENERAL ELEVATION NOTES:
1. THE ELEVATIONS SHOWN ARE NOT ACTUAL ELEVATIONS AND GRADES. THEY ARE SHOWN FOR REFERENCE ONLY AND TO GIVE AN APPROXIMATION OF THE ELEVATIONS ACROSS THE SITE.
 2. THE GENERAL CONTRACTOR IS RESPONSIBLE FOR PROVIDING ALL GRADING, ENGINEERED FILL, COMPACTION TO PROVIDE A LEVEL BUILDING PAD WITH GRADES SLOPING AWAY FROM THE BUILDING ON ALL SIDES.
 3. THE GENERAL CONTRACTOR IS RESPONSIBLE FOR PROVIDING A WALKWAY FROM THE EDGE OF THE ROADWAY TO THE BUILDING THAT IS SLOPED IN SUCH A WAY THE SITE DRAINAGE WILL NOT ACCUMULATE OR WASHOUT THE WALKWAY.

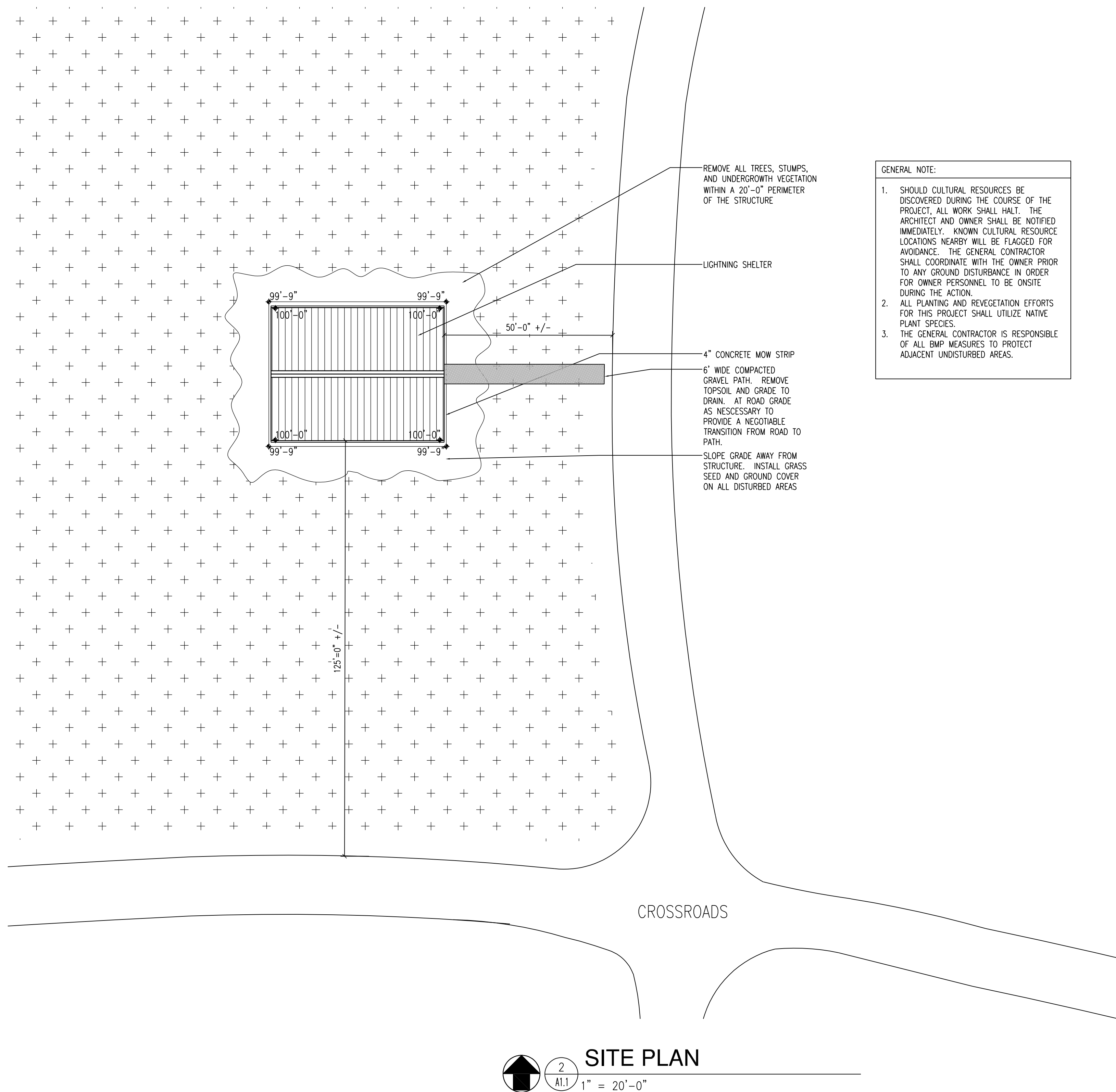

- GENERAL NOTE:
1. SHOULD CULTURAL RESOURCES BE DISCOVERED DURING THE COURSE OF THE PROJECT, ALL WORK SHALL HALT. THE ARCHITECT AND OWNER SHALL BE NOTIFIED IMMEDIATELY. KNOWN CULTURAL RESOURCE LOCATIONS NEARBY WILL BE FLAGGED FOR AVOIDANCE. THE GENERAL CONTRACTOR SHALL COORDINATE WITH THE OWNER PRIOR TO ANY GROUND DISTURBANCE IN ORDER FOR OWNER PERSONNEL TO BE ONSITE DURING THE ACTION.
 2. ALL PLANTING AND REVEGETATION EFFORTS FOR THIS PROJECT SHALL UTILIZE NATIVE PLANT SPECIES.
 3. THE GENERAL CONTRACTOR IS RESPONSIBLE OF ALL BMP MEASURES TO PROTECT ADJACENT UNDISTURBED AREAS.



CONSTRUCTION
 ISSUE

WILLIAMS · BLACKSTOCK
 ARCHITECTS
 ARCHITECTURE INTERIORS PLANNING
 SUITE 200
 2204 FIRST AVENUE SOUTH
 BIRMINGHAM, ALABAMA 35233

ISSUE DATE
 10/05/2023

REVISIONS
 1 4/8/2024

PROJECT NUMBER
 19-054.07

DRAWING TITLE:
 SITE PLAN

SHEET NUMBER
 A1.1